



**FRONT RUNNER**

**JEEP JK (5 DOOR)  
SLIMLINE II - HALF TRAY  
EXTREME RACK KIT**

**ENG**

FAJK001 / KRJW015T

 **INSTALL TIME: 2.5 Hours**

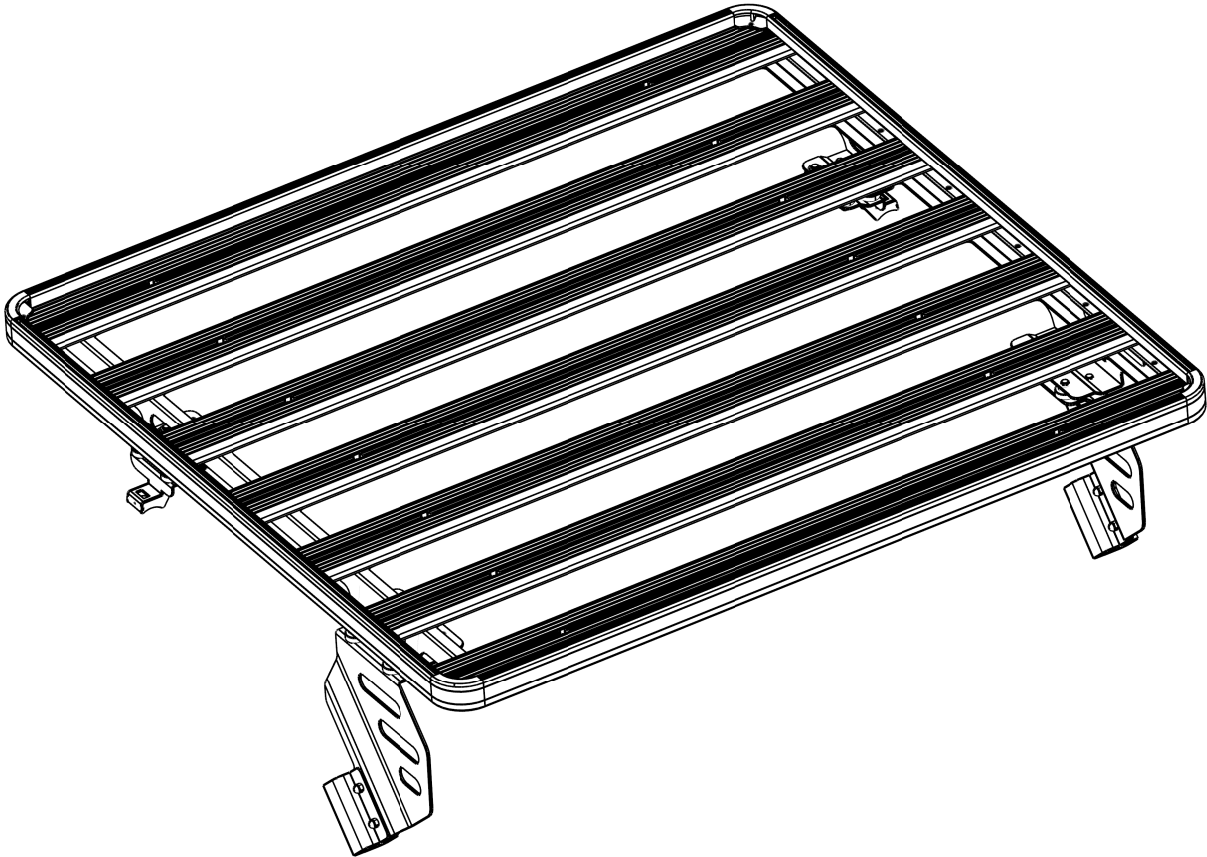

**NOTE:** Your Jeep JK (5 Door) Extreme Roof Rack Kit consists of three boxes. (1) the Tray, (2) the Roll Bar Brackets (FAJK002) and (3) the Tray Support Brackets (FAJK001).

**IMPORTANT WARNING!**

**IT IS CRITICAL THAT ALL FRONT RUNNER PRODUCTS BE PROPERLY AND SECURELY ASSEMBLED AND ATTACHED TO YOUR VEHICLE. IMPROPER ATTACHMENT COULD RESULT IN AN AUTOMOBILE ACCIDENT, AND COULD CAUSE SERIOUS BODILY INJURY OR DEATH TO YOU OR TO OTHERS. YOU ARE RESPONSIBLE FOR ASSEMBLING AND SECURING ALL FRONT RUNNER PRODUCTS TO YOUR VEHICLE, CHECKING THE ATTACHMENTS PRIOR TO USE, AND PERIODICALLY INSPECTING THE PRODUCTS FOR ADJUSTMENT, WEAR, AND DAMAGE. THEREFORE, YOU MUST READ AND UNDERSTAND ALL OF THE INSTRUCTIONS AND CAUTIONS SUPPLIED WITH YOUR FRONT RUNNER PRODUCT PRIOR TO INSTALLATION OR USE. IF YOU DO NOT UNDERSTAND ALL OF THE INSTRUCTIONS AND CAUTIONS, OR IF YOU HAVE NO MECHANICAL EXPERIENCE AND ARE NOT THOROUGHLY FAMILIAR WITH THE INSTALLATION PROCEDURES, YOU SHOULD HAVE THE PRODUCT INSTALLED BY A PROFESSIONAL INSTALLER OR OTHER QUALIFIED PERSONNEL.**

# 1 GET ORGANIZED

Your ROLL BAR BRACKET box (FAJK002) contains:

Item #	Quantity	Description
1	2	INNER ROLL BAR CLAMP
2	2	OUTER ROLL BAR CLAMP
3	28	M6 FLAT WASHER
4	16	FOAM WASHER
5	16	ALUMINUM SPACER
6	16	M6 x 30 HEX BOLT
7	20	M6 NYLOC NUT
8	8	M6 x 20 HEX BOLT
9	20	M6 NUT CAP
10	16	M6 x 19 FLAT WASHER
11	2	REAR SUPPORT BRACKET - (1 LEFT, 1 RIGHT)
12	2	M8 x 75 HEX BOLT
13	2	M8 LARGE WASHER
14	2	MIDDLE SUPPORT BRACKET - (1 LEFT, 1 RIGHT)

## You will need:

- a 5 door Jeep Wrangler
- a Measuring Tape
- a 13mm Flat and 13mm Socket Wrench
- a T40 Torx Wrench
- a Drill Machine
- a 6mm Drill Bit
- a 22mm (7/8") Hole Saw
- a Step Ladder
- a Black and a White Marker
- a clean dry work area near your Jeep
- a Rag and Methylated Spirits/ Denatured Alcohol

\* 16 x Sealing Plug (Not pictured - Refer to Step 7)

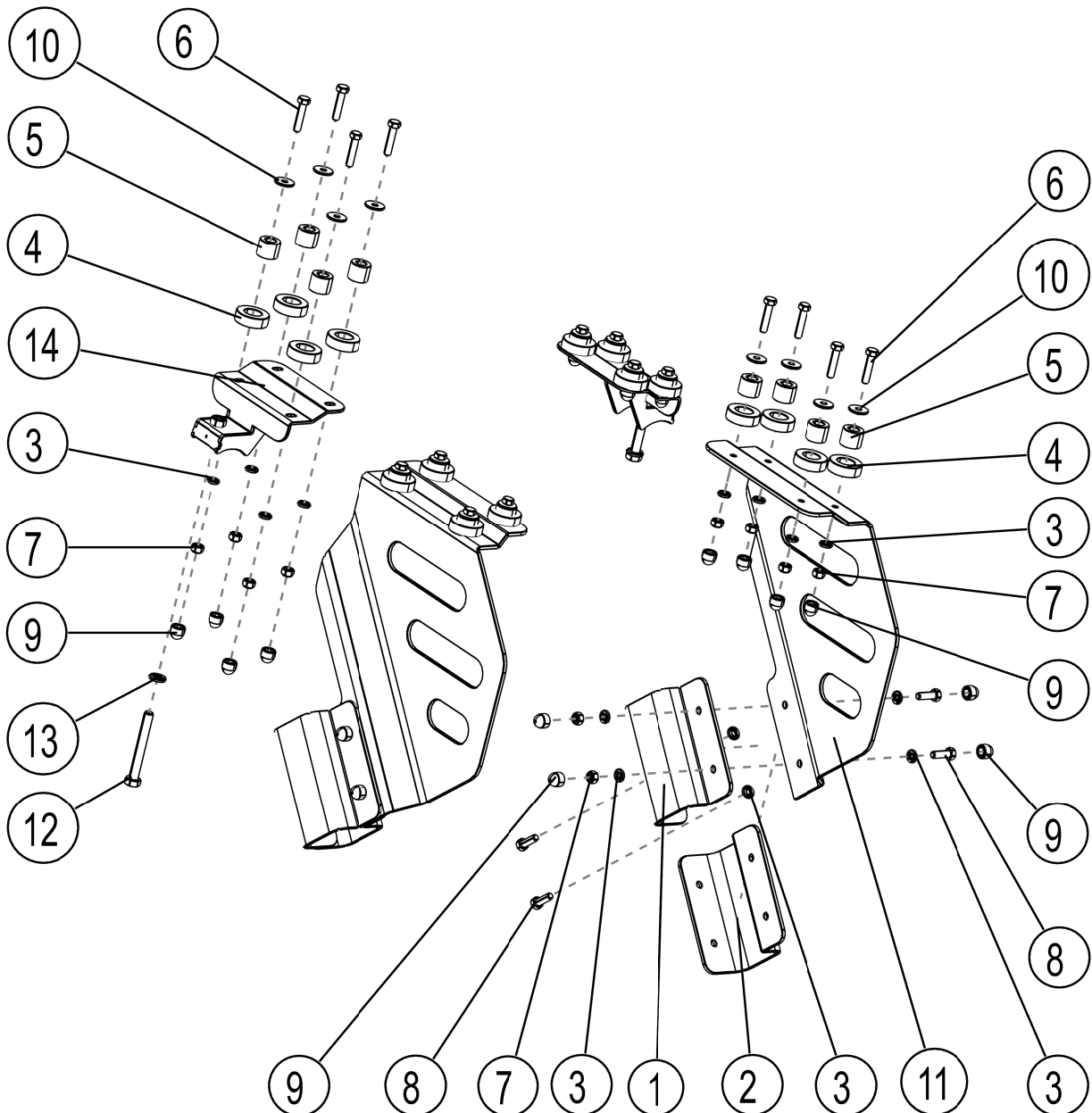

# 1 GET ORGANIZED...CONT.

Your TRAY SUPPORT BRACKET box (FAJK001) contains:

Item #	Quantity	Description
15	14	M8 x 16 HEX BOLT
16	2	TRAY SUPPORT BRACKET - (1 LEFT, 1 RIGHT)
17	14	M8 FLAT WASHER
18	14	M8 NYLOC NUT

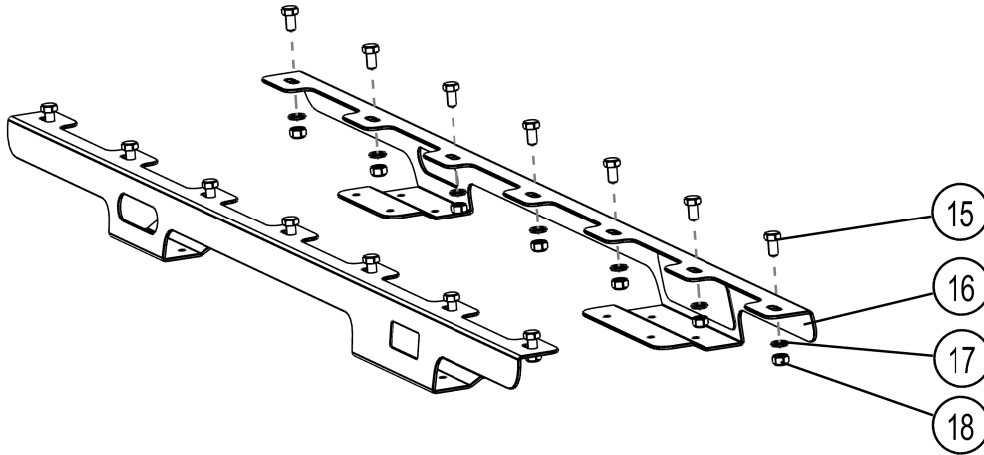

- (A) Familiarize yourself with the parts and then step away from the work area and read through these instructions from beginning to end. Grab a cup of coffee and take a moment. A little prep now may save you a lot of time later.

# 2 PREP FOR INSTALL OF REAR SUPPORT ARMS (FAJK002)

- (A) Loosen velcro, unzip and remove the padding covering the roll bars.

Remove the wiring harness and plastic clip from roll bar.



## 2 PREP FOR INSTALL OF REAR SUPPORT ARMS...CONT.

- ( B ) Locate the two threaded holes on the underside of the roll bar and fasten the two halves of the Roll Bar Clamps (Items 1&2) to the roll bar using Items 8 & 3 and a 10mm Wrench. Place the outer half of the clamp first.



- ( C ) Loosely attach the Rear Support Arms (Item 11) to the outside of the Roll Bar Clamps using Items 3, 7 & 8. Make sure the foot faces the inside of the vehicle and the contours of the foot match the contours of the roof as shown.

Using a suitable marking pen, mark the position of the four holes in the foot on the roof.

Once the holes have been marked. Remove the Rear Support Arms.



- ( D ) Pilot drill the marked holes using the 6mm drill bit. There is NO NEED for a lot of upward pressure. Let the drill do the work - your job is to keep the drill steady.



### 3 PREP AND INSTALL MIDDLE SUPPORT ARMS (FAJK001)

- (A) Locate the Tray Support Bracket in position by lining up the holes in the bracket with the holes drilled in Step 2D.

Place a M6 x 30 Hex Bolt (Item 6) into each hole to keep its location.

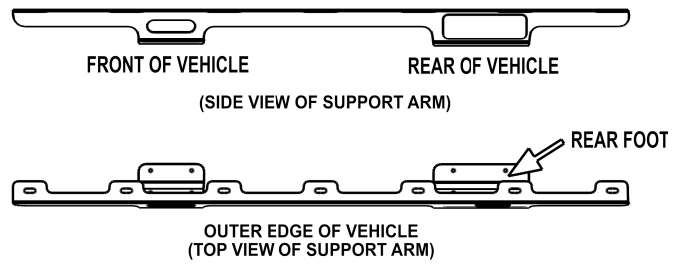

- (B) Using a measuring tape and the rib in the roof as a reference, adjust the front of the bracket so that the entire length of the bracket is parallel with your reference rib.

Once you are happy with your measurements and alignment, use a white marker or suitable marking pen and mark the four holes in the foot of the Tray Support Bracket onto the roof.

Remove the Tray Support Bracket.

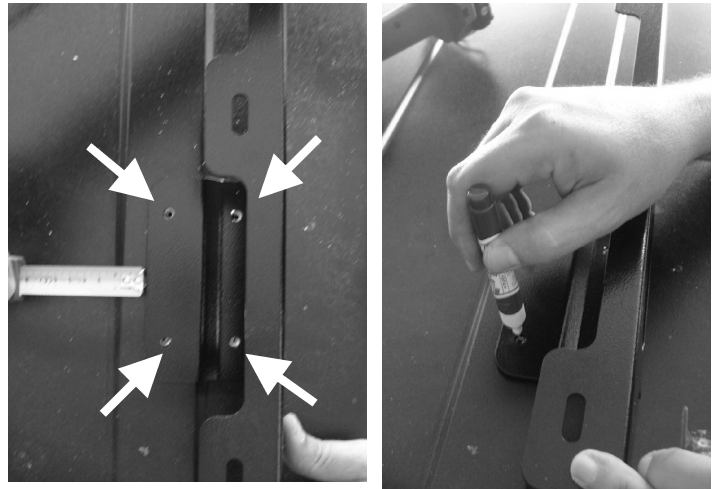

- (C) From outside the vehicle, using your 6mm drill bit, drill four pilot holes through the marks you just made.

- (D) Repeat Steps 2A to 3C for the opposite side.

- (E) Change from the 6mm drill bit to a 22mm hole saw. From the outside of the vehicle drill all the 6mm holes (16 in total) out to 22mm. Once again, let the drill do all the work. You do not want to scratch or damage your vehicle's roof. You may wish to have a friend inside the vehicle with a vacuum cleaner underneath where you are drilling to catch all the dust and keep your vehicle clean.



### 3 PREP AND INSTALL MIDDLE SUPPORT ARMS...CONT.

- ( F ) Pull back the padding around the roll bar above the rear seats and insert Items 12 & 13 (from FAJK002 box) through the hole as indicated.

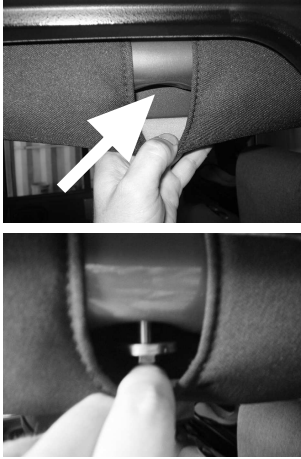

- ( G ) From the inside of the vehicle, in the same position as where you just inserted the bolt in Step 3E, push the Middle Support Bracket (Item 14) through the hole in the roll bar padding and loosely fasten to the roll bar.

Please note that there is a left hand and right hand bracket. The arrow on the bracket must point to the REAR of the vehicle.

Install both sides.

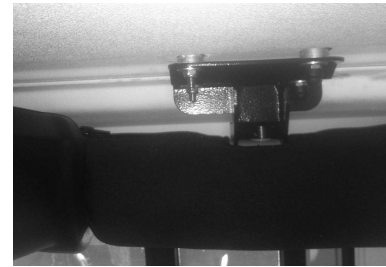
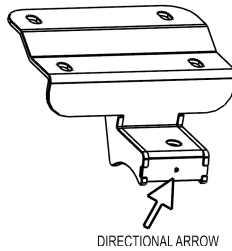

### 4 INSTALL REAR SUPPORT ARMS

- ( A ) Refit and fasten the Rear Support Arms as in Step 2C



## 5 PREP FOR RACK INSTALL (FAJK003)

- (A) Clean the area around all the 22mm holes drilled in the roof with rag and methylated spirits/denatured alcohol.

Insert the Aluminum Spacers (Item 6) into the Foam Washer (Item 5). Remove the paper backing from the Foam Washer to expose the adhesive.

Insert the washer/spacer combination, adhesive side down, into the 22mm holes so that the spacer comes to rest on the Rear Support Brackets underneath.

Firmly press the foam washer all the way around securing it to the roof.

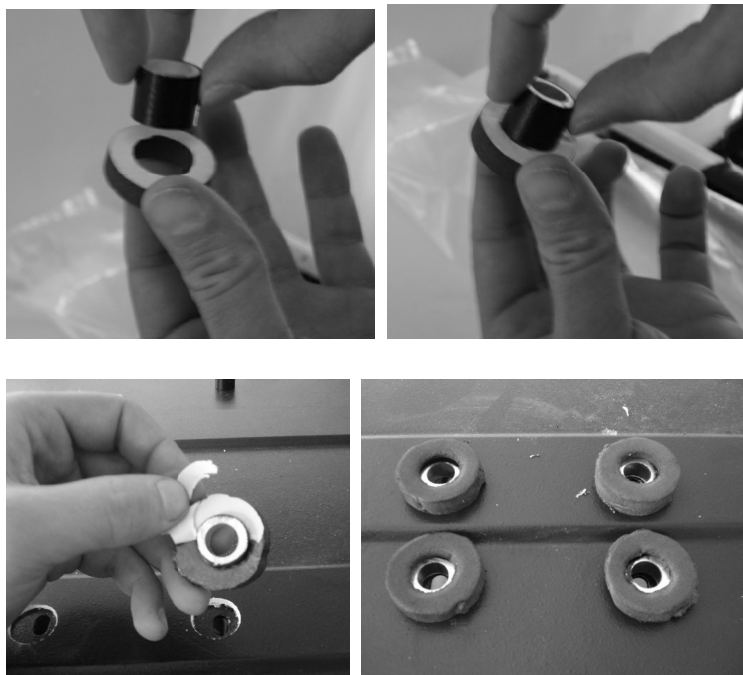

- (B) If not already assembled, assemble your Tray as per the Universal Tray Assembly Instructions (Document RRSTUNI)

- (C) After fitting the Wind Deflectors, the Tray should still be upside down, loosely mount the Tray Support Brackets (from FAJK001 box) to the Tray using Items 15,17&18. As before use the machined slots to insert the Hex Bolts into the Slots.

The rear of the Tray Support Bracket must mount onto the very last Slat (Combined Slat) and approximately 80mm in from the outer edge of each side of the Tray. Do not tighten the bolts yet.

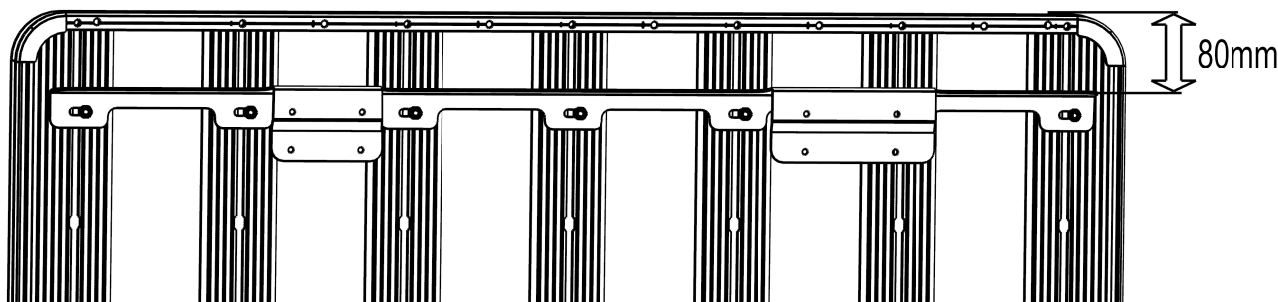

You're almost finished. Take a quick breather before mounting your Tray to your Jeep.

## **6 MOUNT YOUR TRAY**

- ( A )** With the help of a friend, flip the Tray end over end so that it is in the upright position. (The Tray is flipped end over end so that bolts and brackets do not slide left and right).

With one of you on either side of the Tray, lift the Tray and walk it into position above the vehicle, approaching from the rear of the vehicle, making sure that the Wind Deflector faces forward.

The Tray Support Brackets should still be loose enough to move. Line the brackets up with the holes on the roof and fasten them into position using Items 3, 6, 7 & 10 (from FAJK002 box).

Centre the Tray from left to right. Use a tape measure to double check. Once you are happy that the Tray is in the correct position, fasten all nuts and bolts securely, both inside and outside of the vehicle on all brackets that were installed.

Push the Plastic Nut Caps (Item 9 from FAJK002 box) provided over all the exposed bolts and close up all the roll bar padding.

Take a step back and admire your work. Good job!





## 7 REMOVING YOUR RACK

- (A) Should you wish to remove your rack, you will need to plug the holes you drilled in the roof (Step 3E), using the supplied Sealing Plugs (from FAJK002 box, see image - 16 Supplied)

Remove the Tray, and the Tray Support Brackets, by reversing the installation procedure. Leave the Foam Washers and the Aluminum Spacers in place. Screw in the Sealing Plugs reusing the M6 Nyloc Nuts and Washers that held the Tray Support Brackets in position.

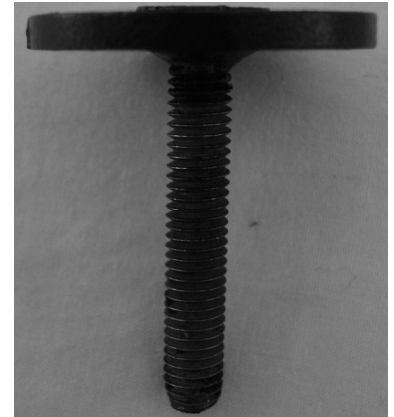

## 8 TAKE A TRIP

- (A) After your first adventure, check that all nuts, bolts, screws and fittings are tight. Re-tighten where needed. You'll find a small amount of settling has happened.

Go on many more adventures, periodically checking all bolts, screws and fittings.



Front Runner can not recommend a maximum load carrying capacity. Please refer to your vehicle manufacturer's recommendations.

## 9 INSTALL OTHER VEHICLE AND RACK ACCESSORIES

- (A) Now's the time to visit your favorite Front Runner dealer in person or online.