

## READ ME ! ⚠

Thank you for purchasing a Jeep JL Interior Shelf.

Before you start, take a moment to familiarize yourself with the Fitting Instructions and the included components.

Refer to Page 2 for a list of all the components, quantities and tools required.

## IMPORTANT WARNING! ⚠

IT IS CRITICAL THAT ALL FRONT RUNNER PRODUCTS BE PROPERLY AND SECURELY ASSEMBLED AND ATTACHED TO YOUR VEHICLE. IMPROPER ATTACHMENT COULD RESULT IN AN AUTOMOBILE ACCIDENT, AND COULD CAUSE SERIOUS BODILY INJURY OR DEATH. YOU ARE RESPONSIBLE FOR ASSEMBLING AND SECURING ALL FRONT RUNNER PRODUCTS TO YOUR VEHICLE, CHECKING THE ATTACHMENTS PRIOR TO USE, AND PERIODICALLY INSPECTING THE PRODUCTS FOR ADJUSTMENT, WEAR AND DAMAGE. THEREFORE, YOU MUST READ AND UNDERSTAND ALL OF THE INSTRUCTIONS AND PRECAUTIONS SUPPLIED WITH YOUR FRONT RUNNER PRODUCT PRIOR TO INSTALLATION OR USE. IF YOU DO NOT UNDERSTAND ALL OF THE INSTRUCTIONS AND CAUTIONS, OR IF YOU HAVE NO MECHANICAL EXPERIENCE AND ARE NOT THOROUGHLY FAMILIAR WITH THE INSTALLATION PROCEDURES, YOU SHOULD HAVE THE PRODUCT INSTALLED BY A PROFESSIONAL INSTALLER OR OTHER QUALIFIED PERSONNEL.

**NOTE:** Front Runner will not be responsible for any damage caused by the failure to install the product according to these instructions.

Please call us if you have any questions about the installation of this product.

# 1

## GET ORGANIZED

### IN THE BOX

		<b>VACC192</b>
1	1 X	Center Tray
2	2 X	Side Tray - 1LH & 1RH
3	2 X	Side Tray Support - 1LH & 1RH
4	22 X	M6 Nut Cap
5	14 X	M6 x 12 Button Head Bolt
6	8 X	M6 x 16 Button Head Bolt
7	22 X	M6 Nyloc Nut
		<b>VACC207</b>
8	2 X	Mounting Bracket - 1LH & 1RH
9	4 X	M8 x 30 Button Head Bolt
10	4 X	M8 x 25 x 2 Flat Washer

### TOOLS NEEDED



FIGURE 1.1

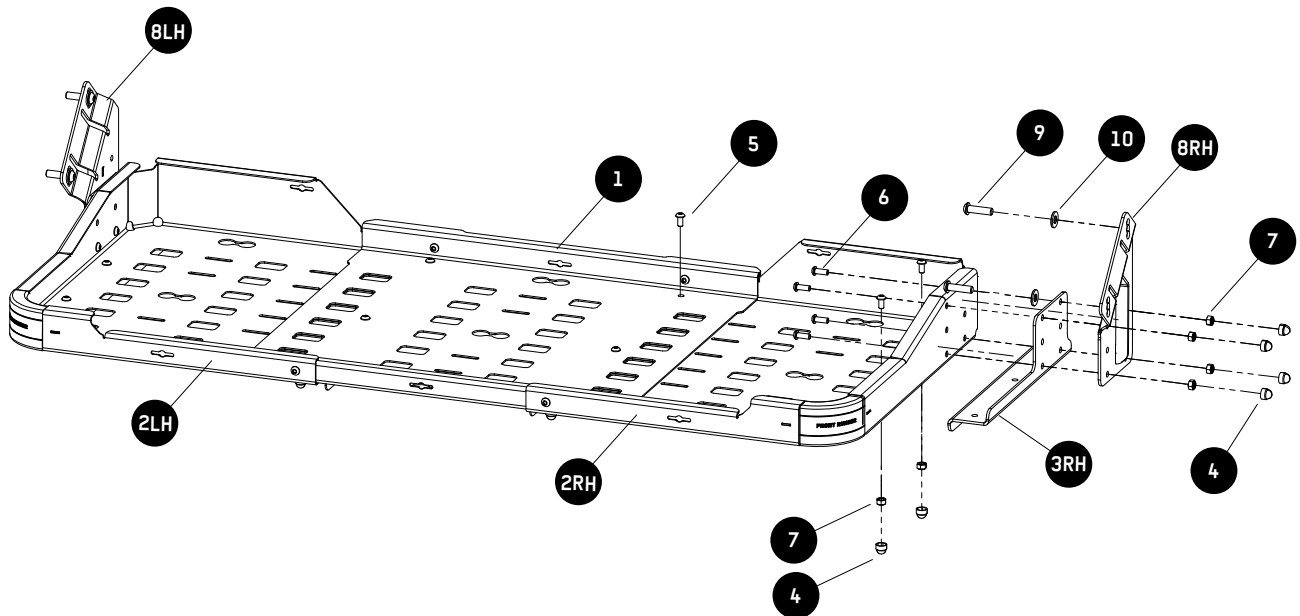

2.1

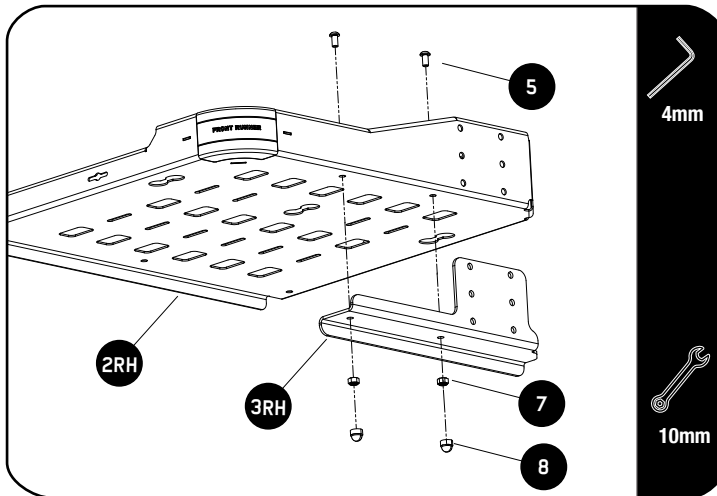

Assemble the Side tray and Side Tray support using M6 x 12 Button Head Bolts and M6 Nyloc Nuts (Items 5 & 7).

Place M6 Nut Caps (Item 8) on the Nyloc Nuts.



#### Tightening Torque:

M6 : 8-10Nm / 5.9 ft lb - 7.38 ft lb

2.2

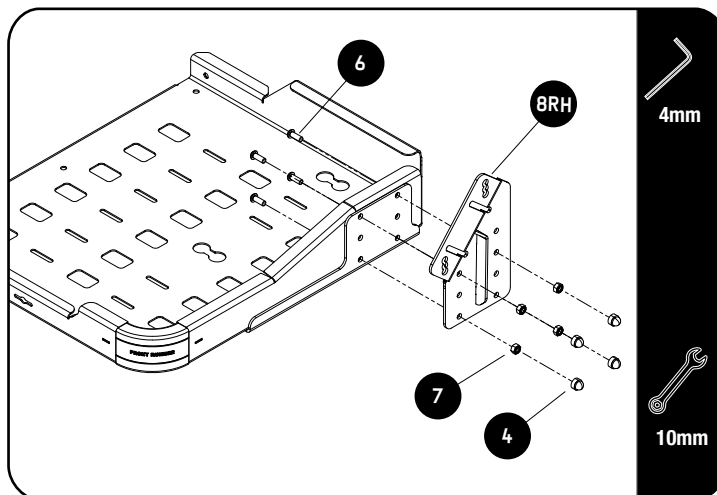

Depending on the space needed, you can install the tray in a Low or High position.

#### MOUNTING BRACKETS IN A LOW POSITION



Assembly the Mounting Bracket (Item 8) to the Side Tray assembly using M6 x 16 Button Head Bolts and M6 Nyloc Nuts (Items 6 & 7).

Place M6 Nut Caps (Item 4) on the Nyloc Nuts.

2.3

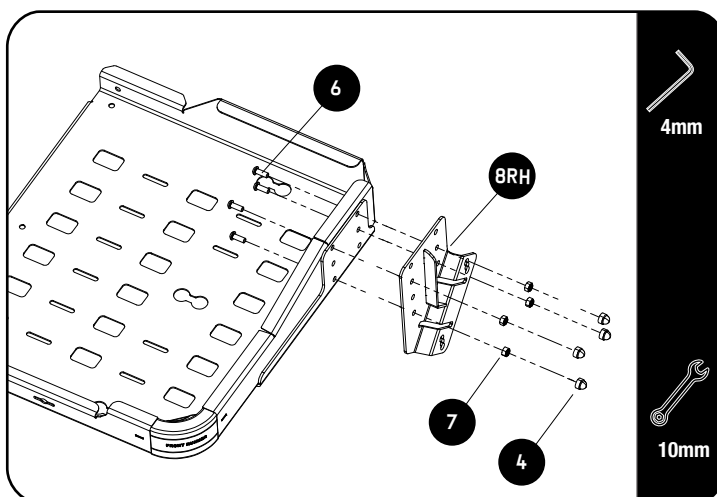

#### MOUNTING BRACKETS IN A HIGH POSITION



Assembly the Mounting Bracket (Item 8) to the Side Tray assembly using M6 x 16 Button Head Bolts and M6 Nyloc Nuts (Items 6 & 7).

Place M6 Nut Caps (Item 4) on the Nyloc Nuts.

2

## FIT AND SECURE

2.4

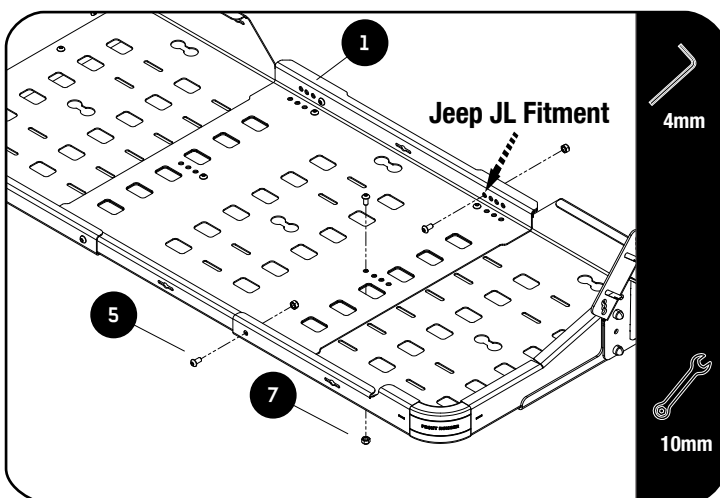

Loosely assemble both Side Trays to the Center Tray (Item 1) using M6 x 12 Button Head Bolts and M6 Nyloc Nuts (Items 5 & 7).

**NOTE:** On a Jeep JL you will use the forth hole from the side.

The fasteners will be fully tightened after the tray is fitted in the vehicle.

2.5

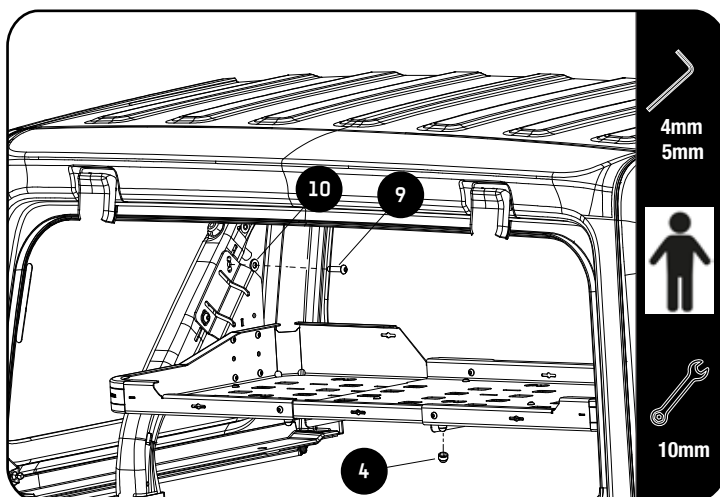

Remove the two plastic covers located on the inside of the roll bar.

With the help of a friend, lift the tray into position and secure using M8 x 30 Button Head Bolts and M8 x 25 Flat Washers (Items 9 & 10) as shown.

Fully tighten all fasteners.

Place M6 Nut Caps (Item 4) on the Nyloc Nuts.



### Tightening Torque:

M8 : 15-20Nm / 11.06 ft lb - 14.75 ft lb

3

## FINISH

Congratulations! You did it. Take a step back and admire your work!

4

## INSTALL OTHER VEHICLE AND RACK ACCESSORIES

Now's the time to visit your favorite Front Runner Dealer in person or online.

Be sure to tag us. We love to see our gear in action! #FrontRunnerOutfitters

Share your adventures on:

